

# Deriah Aboriginal Area

- Dedicated under the Brigalow Nandewar Community Conservation Act 2005 NSW
  - 2233 hectares
  - 22 Kilometres East of Narrabri
  - Deriah forest is a significant place for the Gamilararay people it contains numerous sites, evidence of travelling, trading and culture.
  - The area is Co-managed/ Joint managed by the Deriah Co-management Committee and the NSW National Parks and Wildlife Service.
- 
- Community Reps include:
    - Steven Booby
    - Marilyn Binge
    - Simone Moodie
    - Donald Saunders
    - Simon Smith
    - Ann Williams

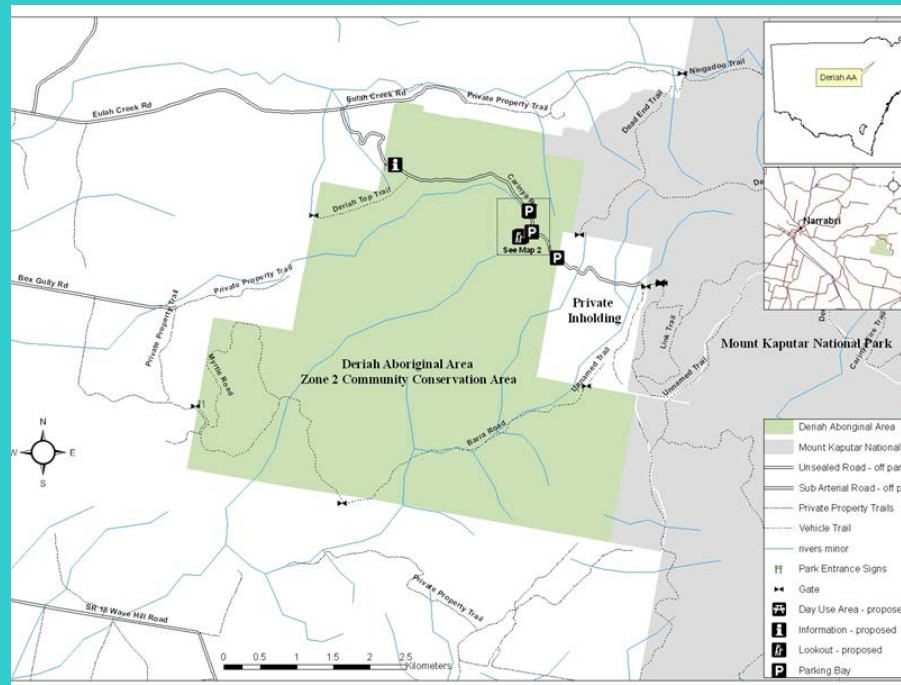

# Co-Management Projects Completed

- 5 Years of Operation
- MOU Signed 7<sup>th</sup> November 2011
- Day Use Area (Open to Public)
- Open Day
- Deriah Aboriginal Area Education Package

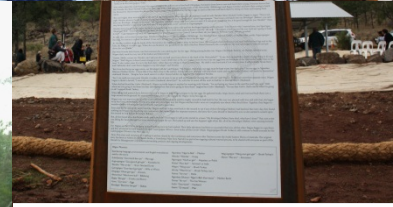



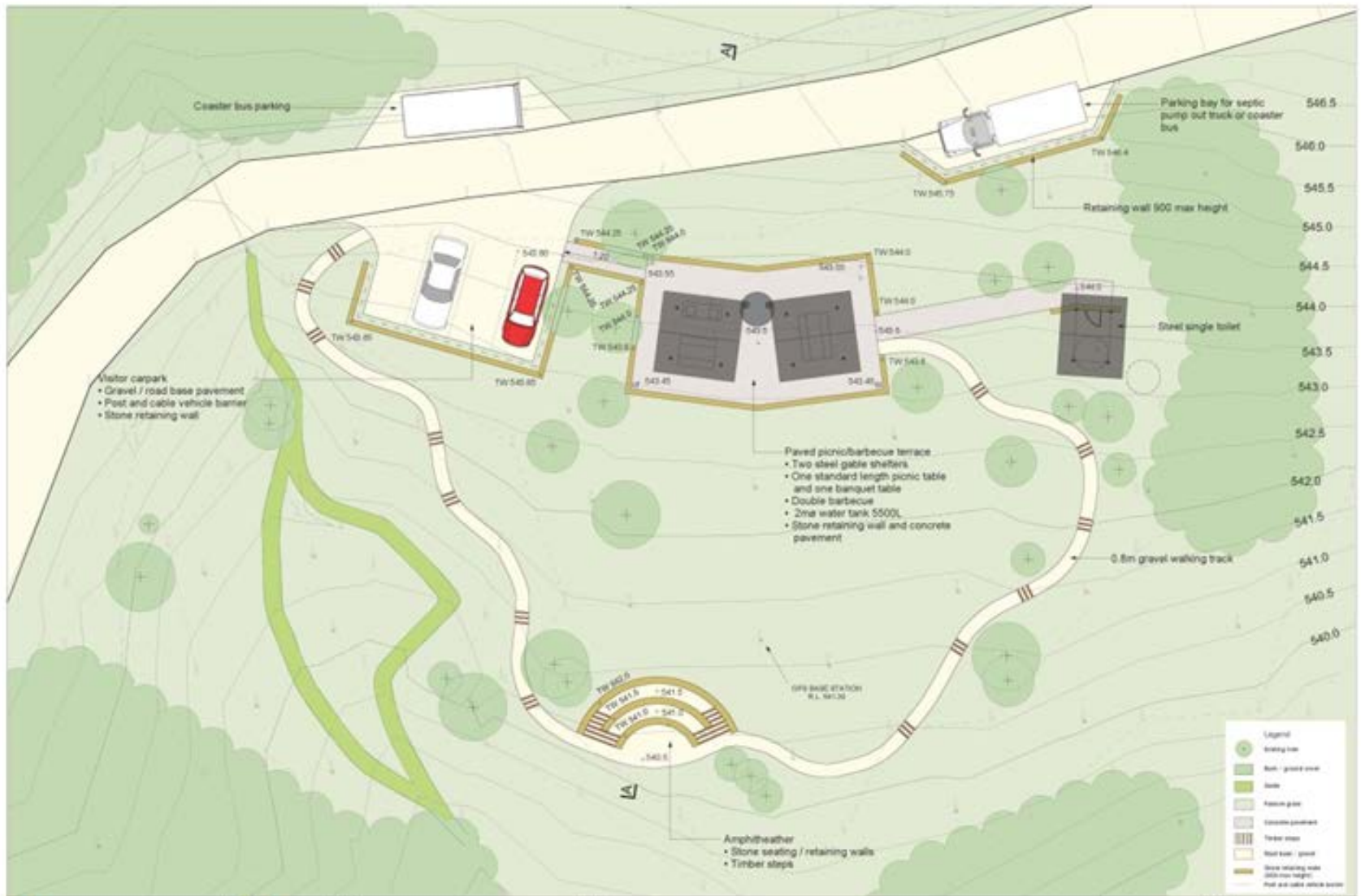

# Co-Management Projects Planned

- *Wagun Walaay* Brush Turkey Nest

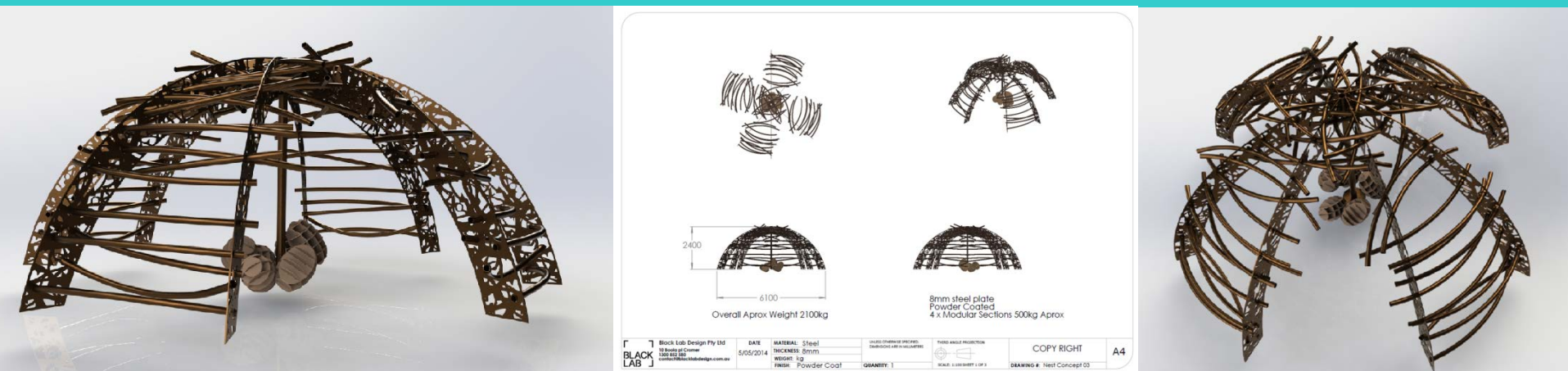

- Stencilling/ Rubbing Plates



- Family Sculptures
- Brush Turkey Sculptures
- Entrance Sign
- Cultural Camps
- Walking Tracks
- Food Medicine Garden
- Tourism/ Education Development

# Co-Management Aim

- Facilitate Education
- Renew Community Knowledge
- Foster Ownership/ Responsibility
- Share genuine cultural knowledge with whole community
- Getting Things Done in our time
- Equal & varied viewed of input
- & World Peace





















# YALUU

